

## TERMINAL BLOCKS

- 5mm Pitch
- Screw Terminal
- 2 - 12 pole end stackable
- 2.5mm<sup>2</sup> wire acceptance
- UL/CE/VDE approved

## 5MM PITCH 90° SCREW TERMINAL

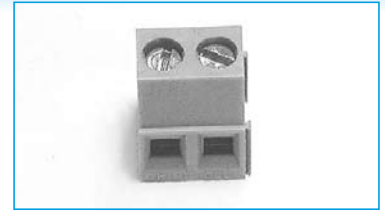

### SPECIFICATION

#### Electrical Characteristics

<b>Rating Current:</b>	17.5A/380V	<b>Pin/terminal:</b>	5μ tinned, nickel plated brass
<b>Contact Resistance:</b>	≥2.5kV/60sec	<b>Wire protector:</b>	Tin plated phosphor bronze
<b>Insulation Resistance:</b>	≥5MΩ	<b>Screw/torque:</b>	M3 steel, 6μ zinc colour passivated and tropicalised/5Nm
<b>Operating Temperature:</b>	-20°C to +125°C	<b>Recommended PCB hole size:</b>	ø1.1mm
<b>Short Period:</b>	160°C		
<b>Moulding:</b>	UL94-V0 flame retardant Lexan		

### OUTLINE DRAWING

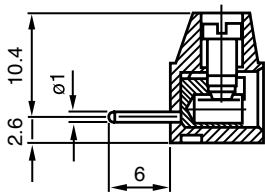

### ORDERING INFORMATION

DBC	TB	43	/2
Dubilier Connectors	Series Terminal Blocks	Style	No of Ways 2 = 2ways 3 = 3ways
			* other number of ways are available Please consult the office for further details

## TERMINAL BLOCKS

- 5.00 mm pitch
- Stamped insert
- Rating 24A/250V
- UL/VDE/CE approved
- Screw terminal
- 4.0mm<sup>2</sup> wire acceptance

## 5mm PITCH VERTICAL MOUNT

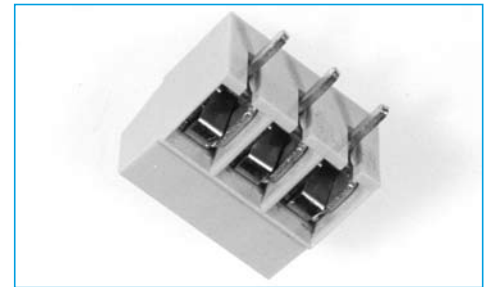

### SPECIFICATION

<b>Rating:</b>	24A/250 Vac	<b>Pin/terminal:</b>	5 micron tinned nickel plated brass
<b>Dielectric Strength:</b>	>2.5KV	<b>Wire Protector:</b>	Tin plated phosphor bronze
<b>Insulation Resistance:</b>	>5MΩ	<b>Screw/torque:</b>	M2.5 Zinc Steel / 0.5NM, colour passivated and tropicalised
<b>Working temperature:</b>	-20°C to 125°C	<b>Recommended PCB hole size:</b>	ø1.3mm <sup>2</sup>
<b>Short Period:</b>	160°		
<b>Moulding:</b>	UL94V-0 flame retardant nylon 66		

### OUTLINE DRAWING

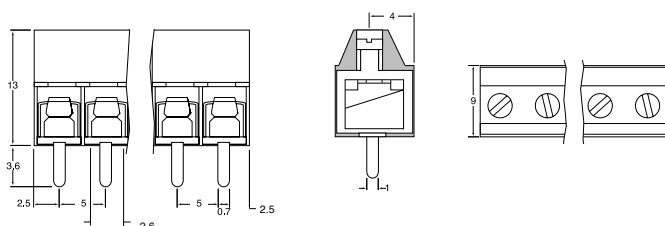

### ORDERING INFORMATION

DBC	TB	10	/2
Dubilier Connectors	Series Terminal Block	Style	N° of Ways 2 = 2 ways 3 = 3 ways
			* Other Number of ways are available up to 24 Please consult office for further details